

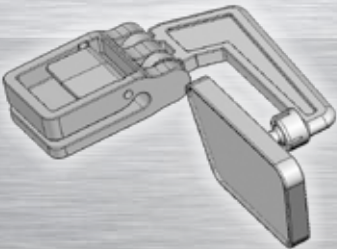

WHO'S GOT YOUR BACK?



GOBLIN® Peripheral Vision System™ alerts you to movement around and behind you; reducing the risk of injury or death from approaching vehicles, heavy equipment and other hazards.



GOBLIN® Peripheral Vision System™

- Adds Up to 180° of Peripheral Vision (Does NOT Block Forward Vision)
- Made of Industrial-Grade Plastic Polymer
- Acrylic Mirrors are Scratch-Resistant & Tinted to Prevent Glare
- Clips Easily to Brim of Most Hard Hats
- Unique "Breakaway" System (To Prevent Injury)
- Storage System Included
- Meets WAC 296 155 305 Standards
- Made in the USA

GOBLIN® Peripheral Vision System™ was designed to work in conjunction with standard safety protocol and other Personal Protective Equipment (PPE).

www.hardhatmirror.com

Sales Information:

360.825.1505

When does a hard hat mirror become a Peripheral Vision System™?
(see back for details)



GOBLIN® Peripheral Vision System™

Safety Innovation

From Hard Hat Mirrors to GOBLIN® Peripheral Vision System™

Runovers and backovers in the work zone are a serious safety concern for the general/construction industry. OSHA categorizes "Struck-By" as one of the top four construction hazards. OSHA Quick Card 3216-6N-06

Each year more than 100 workers are killed in the highway and street construction industry. Vehicles and equipment operating in and around the work zone are involved in over half of the worker fatalities.

<http://www.cdc.gov/niosh/docs/2001-128/>

- In 2005 there were 414,000 construction injuries
 - Injuries from contact with objects and equipment- 16%
 - 157,000 injuries caused lost workdays
- <http://www.elcosh.org/docs/d0100/d000038/sect32.html>

On October 18, 1999, Kim Vendl was killed when a dump truck she never saw coming backed over her at 5mph. In response Washington state enacted WAC 296 155 305, which recommends using hard hat mounted rear-view mirrors "to warn and protect...from traffic and equipment approaching from behind."

<http://www.cdc.gov/NIOSH/FACE/stateface/wa/99wa070.html>

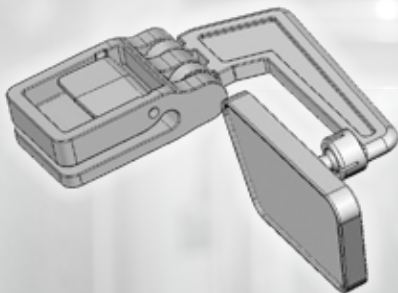

Rear-View Mirrors vs Peripheral Vision System™

Rear-view Mirror challenges:

- A mirror in close proximity to your eyes makes it difficult to focus.
- The shape/size of the mirror distorts and blocks direct vision.
- Wearing only one mirror is ineffective.

GOBLIN® Peripheral Vision System™ solutions:

- The mirrors alert you to movement without looking directly in them.
- When adjusted properly, the system expands your peripheral vision without blocking direct vision.
- Using two mirrors alerts you to danger from all directions.



Keeping Safety in Site™

"At Neuwaukum Industries, our collective mission is to save lives, prevent injuries, and improve job safety by providing innovative products that meet the demands of today's work place."

Donn Bauer Jr., Founder, Neuwaukum Industries, Inc. (NII)

WHO'S GOT YOUR BACK?
GOBLIN® Peripheral Vision System™